

TECHNICAL INFORMATION

Broken Arrow Performing Arts Center

701 South Main Street
Broken Arrow, Oklahoma 74012
Ph: 918.259.5778
Fax: 918.258.8923
www.brokenarrowpac.com

CONTACT INFORMATION:

Kim Vento

Executive Director

Ph: 918.259.5723

Email: kim@brokenarrowpac.com

Matt Morton

Technical Director

Ph: 918.259.7707

Email: mmorton@baschools.org

Maddison Riggin

Box Office Manager

Ph: 918.259.5778

Email: mriggin@baschools.org

Shannon Walsh

Events Coordinator

Ph: 918.259.5760

Email: swalsh@baschools.org

Curt Cox

Production Specialist

Ph: 918.259.7707

Email: ccox@baschools.org

Adam Crowell

Kirkland Theatre Manager

Ph. 918.505.5275

Email: acrowell@baschools.org

SEATING

- Overall seating capacity: 1490 seats + 17 wheelchair accessible spaces
- Orchestra level: 717 + 13 wheelchair accessible spaces
- Mezzanine level: 310
- Lower Balcony level: 328
- Upper Balcony level: 135 + 4 wheelchair accessible spaces

STAGE

- Proscenium opening: **47'-11" W x 22'-10" H**
- Depth of stage from Plaster Line to back wall: **39'-2"**
- Depth of workable stage with Orchestra Pit covered (approx., from center): **49'-2"**
- Plaster line to DS edge of Apron: **5'-8"**
- Plaster line to DSC edge of pit: **13'-8"**
- Stage width, Center to SR: **50'-10"**
- Stage width, Center to SL: **38'-6"** – With 15' SL alcove, total SL wing: **53'-6"**
- Grid height: **64'-10"**
- FOH light and sound position from stage along HR / SL wall: **125'**
- FOH light and sound position, direct from proscenium line: **85'**
- Audience to the stage lip: **3'-6"**
- 3 traps, located DSC, CSL and CSR.

LOAD IN & OUT

- Loading dock is located at the South East corner of the building.
- Loading dock can accommodate 2 trucks **or** 1 truck and 1 bus concurrently (dock width: 23').

- (2) Mechanical dock levelers.
- Vehicles may remain parked at dock overnight.
- Loading dock door: **10'-4"h x 10'w**
- Dock Height: **3'-11"**
- Stage loading door: **20'h x 16'w**
- Shore power: (1) 50a receptacle and (1) 30a receptacle located immediately inside dock door.

LIGHTING

- Control location: Front of house, orchestra level, 85' from proscenium
- Lighting control: ETC EOS Titanium Console.
- ETCNet throughout venue.
- Dimming: 384 ETC Sensor Dimmers - dimmer per circuit, 2.4kW ea.
- See circuit plot file for circuit location detail. Available on request.
- Company Switches: (2) 400a 3-phase switches, USL, camlock; (2) 200a 3-phase switches, DSL, bare wire connect.
- Follow Spots: (1) Cyrano HMI 2500 Spotlight and (1) Lycian 1290 XLT
- House control: can be controlled from lighting console or from keypads located DSL, DSR and FOH booth.
- (1) Ultratec Radiance hazer available.
- **No pick points. Cables must be picked from grid.** House rope available.
- For detailed lighting instrument and accessory inventory, separate attachment available.

SOUND

- Mix position: Front of house, orchestra level, 85' from proscenium.

- Console: Yamaha CL5 48-channel Digital Mixer
- Speakers: Bose RoomMatch 6-box progressive directivity arrays left, center, right proscenium. 8 Bose RMS-215 subs in a steered compound bass array; 2 Yamaha CW218V dual 18' subs (floor). Meyer UPJ-1P balcony fills and 2 Meyer UPM-1P and 4 Community CPL23 front fills.
- Proper mixing conventions for this system design: This sound system has been designed with a center cluster that functions as a point source with unified arrival to all seats in the house. All information placed in this cluster will have proper phase in all seats. The left and right clusters will be capable of covering all seats but with the normal comb filtering and phase artifacts typical with all stereo systems.

The considerations for the design criteria mentioned above yields a pleasant and enjoyable sound experience for all audience members when mixed accordingly:

Center Cluster:

Kick
 Bass
 Snare
 HiHat
 Lead Vocals
 Solo Instrumentalists

Right and Left Clusters:

Stereo Keys
 Stereo guitars
 Stereo Field appropriate instruments
 'Ear Candy'

Mix the system as you would mix a CD. However, do not soft pan any instruments. Think of the system as a tri-mono system with all rhythmic instruments and lead solos sent to the Center Cluster for the best phase experience. If you mix the system as it was designed for the house you will have a great experience. Remember, what sounds great at FOH will sound great for the rest of the room, if you follow these concepts. Most experienced engineers know these laws of physics, so, have fun.

- **Maximum volume: 90 db at mix position. Please strictly adhere to this guideline.**
- Monitors: (4) independent mixes available, controlled from FOH mixer, utilizing Tannoy V12 and V8 cabinets powered by Bose PM8500 N amps.
- Playback/Recording: QLab on MacBook Pro, Tascam CD-RW901SL Rewritable Recorder, 2-Disc American Audio DCD-PRO310 MKII at FOH, or direct line to board via 1/8" audio jack or XLR.
- Company switches: (2) 400a 3-phase switches, USL, camlock; (2) 200a 3-phase switches, DSL, bare wire connect.
- **For touring sound systems: Tie-in to hearing assist system required.** (1) XLR program line needed to USL.

- **For touring sound systems:** Tie-in to house monitor system **required**. (1) XLR program line needed at house mix position.
- If touring audio is employing house speakers, tie-ins are unnecessary.
- For detailed mic and supply accounting, sound inventory file available.

RIGGING

- All stage rigging is motorized and electronically controlled by ETC Foundation HD Rigging Controller located DSR wing.
- All pipes have a programmed maximum set speed – **cannot exceed this speed**.
- Pipes are 64' in length.
- **No pick points. Cables must be picked from grid.** House rope available.
- 40pc. Sch 40 pipe and tie-down ratchets available for spanning grid.
- See Line Set attached below for details.

PROJECTION

- 16k Lumen Panasonic PT-MZ16KL Projector
- Media player tie-in available at DSL and Booth locations, HDMI inputs. House has some adapters to other input types.
- Dell Latitude 5491 available.
- House screen: 25'h x 19'w, front or rear project, located on line set 3.
- Can project to house screen, cyclorama, or onstage scrim.

DRESSING

- (3) traditional dressing rooms: (1) two-person star dressing room, (1) five-person dressing room, (1) fourteen-person chorus dressing room.

- Each dressing room is equipped with a full-length mirror, lighted mirrors, lavatories, seating, (2) clothing racks, communication with SM and show monitor with volume control.
- (1) multi-use green room. Green room can double as dressing if needed. It has a lavatory, seating, communication, show monitor and clothing racks are available, but is not equipped with lighted mirrors.
- Additional dressing: The PAC's Flex Space is a flexible usage room. All interior walls are movable, allowing the space to be used as one large rehearsal, storage or meeting area or divided into as many as six separate areas. When fully configured, each area has seating, lighted mirrors, communication with SM and show monitor with volume control, but no plumbing. Additional dressing racks are available for use in the space. **See detail drawing below.**
- (2) showers available. Showers adjacent to star dressing room and green room.
- Dressing rooms and flex space are located at and are accessible from SL of the stage.
- (1) washer and (1) dryer available, located adjacent to SL wing. Additional laundry and dry clean facilities located nearby.
- Clothes steamer, steam irons and ironing boards available.

COMMUNICATIONS

- Call biscuit at stage manager's station to backstage and dressing rooms located DSL.
- Tie-in to tour paging with (1) XLR page line, DSL.
- Clear-Com station in each dressing room and at stage managers' station with available connections downstage and upstage left and right, FOH control position, spot light positions, catwalk, grid, and pit.
- (10) Single-line belt packs, (2) dual-line belt packs and (14) headsets.

ADDITIONAL EQUIPMENT

- Listen LT- 800-216 hearing assist system with 64 personal receiver packs and ear buds.
- Steinway Model B 7.5' Grand Piano, ebony satin finish.
- Yamaha Clavinova CLP-S306 Electric Piano.

- (20) 4x8 Wenger platforms, can be legged to 8", 16", 24", or 32". Black skirting available for masking.
- (1) 4x4 Wenger platform.
- (1) Maestro conductor's stand
- (9) Wenger 4-step choir risers, 6'-6" x 6', can be configured semi-circle or straight.
- (1) large, (2) small lectern, each with microphone.
- 3' x 3' Wenger conductor's podium.
- (80) orchestra stands and (40) stand lights.
- (80) orchestra chairs, black.
- Secoa Maestro acoustical shell, dark wood finish.
- (1) black and (1) white scrim, both 60'w x 30'h.
- Genie AWP-30S Lift.
- Fender Passport Venue 600w portable PA system with (1) wireless mic
- 4', 8', 10' and 12' fiberglass ladders.
- Brooms, mops, mop buckets, shop-vac.
- Various hand carts and hampers.

LOBBY/RECEPTION AREA EQUIPMENT

- Catering kitchen available: has sink, prep area, ice machine, refrigerator, microwave and catering room.
- (16) 6' diameter round tables.
- (17) 6' rectangle folding leg tables.
- (10) 32" bistro-style tables

- Table cloths available.
- (128) white folding reception chairs.

BAPAC LINESET SCHEDULE

Pipe #	House Use	Distance US of Plaster Line	Capacity (lbs.)	Fixed	Speed (ft/sec)	Max. Out
1	Valance	0'-8"	750		1.6	60'
2	Grand Curtain	1'-3"	1200	Fixed	1.6	60'
3	Projection Screen	2'-3"	750	Fixed	1.6	60'
4	Border #1	3'-0"	750		1.6	60'
5	Leg #1	3'-9"	750		1.6	60'
6	Elec #1	5'-3"	2000		0.33	40.6'
7	Free Pipe	7'-7"	750		1.6	60'
8	Band Cloud		2000	Fixed	0.33	60'
9	Border #2	9'-0"	750		1.6	50'
10	Leg #2	10'-0"	750		1.6	60'
11	Elec #2	11'-5"	2000		0.33	41.6'
12	Act Curtain	13'-1"	1200		1.6	60'
13	Free Pipe	14'-4"	750		1.6	60'
14	Band Cloud		2000	Fixed	0.33	60'
15	Border #3	15'-9"	750		1.6	50'
16	Leg #3	16'-6"	750		1.6	60'
17	Elec #3	18'-2"	2000		0.33	45'
18	Free Pipe	20'-1"	750		1.6	60'
19	Band Cloud		2000	Fixed	0.33	60'
20	Border #4	22'-5"	750		1.6	50'
21	Leg #4	23'-2"	750		1.6	60'
22	Elec #4	24'-9"	2000		0.33	45'
23	Free Pipe	26'-4"	750		1.6	60'
24	Border #5	27'-6"	750		1.6	60'
25	Band Cloud		2000	Fixed	0.33	60'
26	Elec #5	30'-5"	2000		0.33	45'
27	Free Pipe	31'-7"	750		1.6	60'
28	Leg #5	32'-5"	750		1.6	60'
29	Free Pipe	33'-0"	1200		1.6	60'
30	Blackout	34'-6"	750		1.6	60'
31	Cyc	36'-3"	1200		1.6	60'

BAPAC First Floor Detail

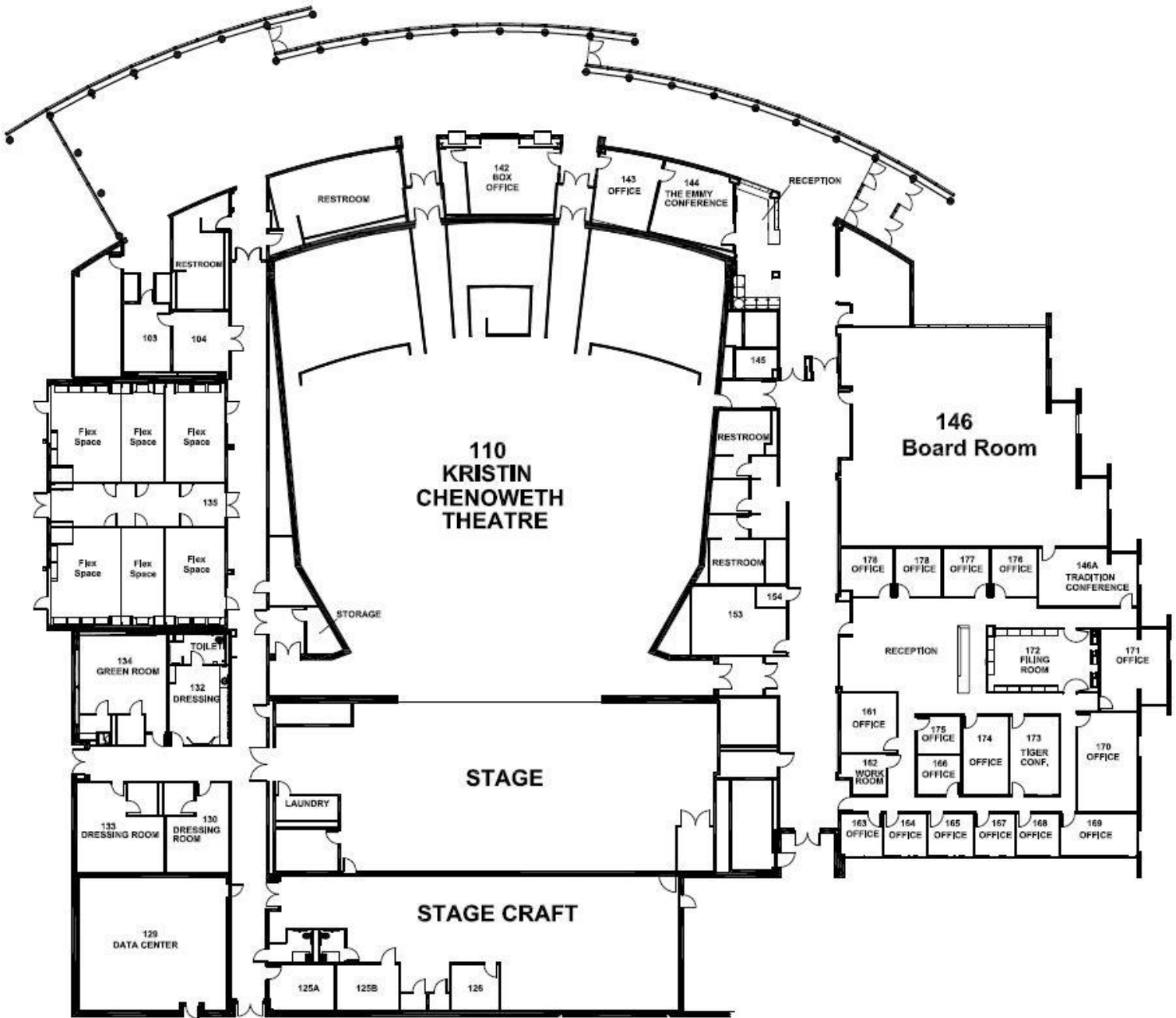

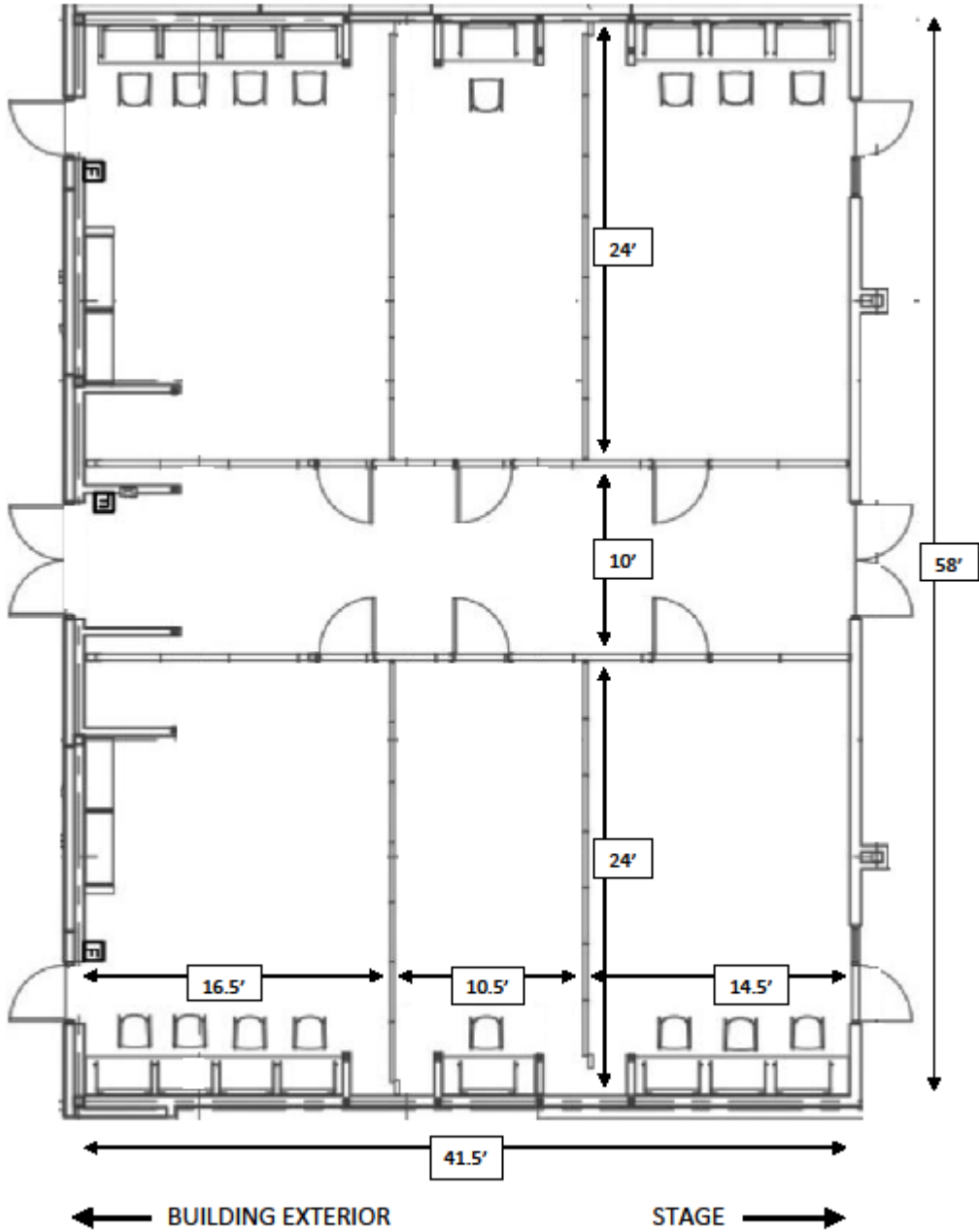

Flex Space Detail

Upper Balcony Total: 137 Seats + 4H & 6 Helper Seats

Lower Balcony Total: 328 Seats

Balcony Total: 465 Seats + 4H & 6 Helper Seats

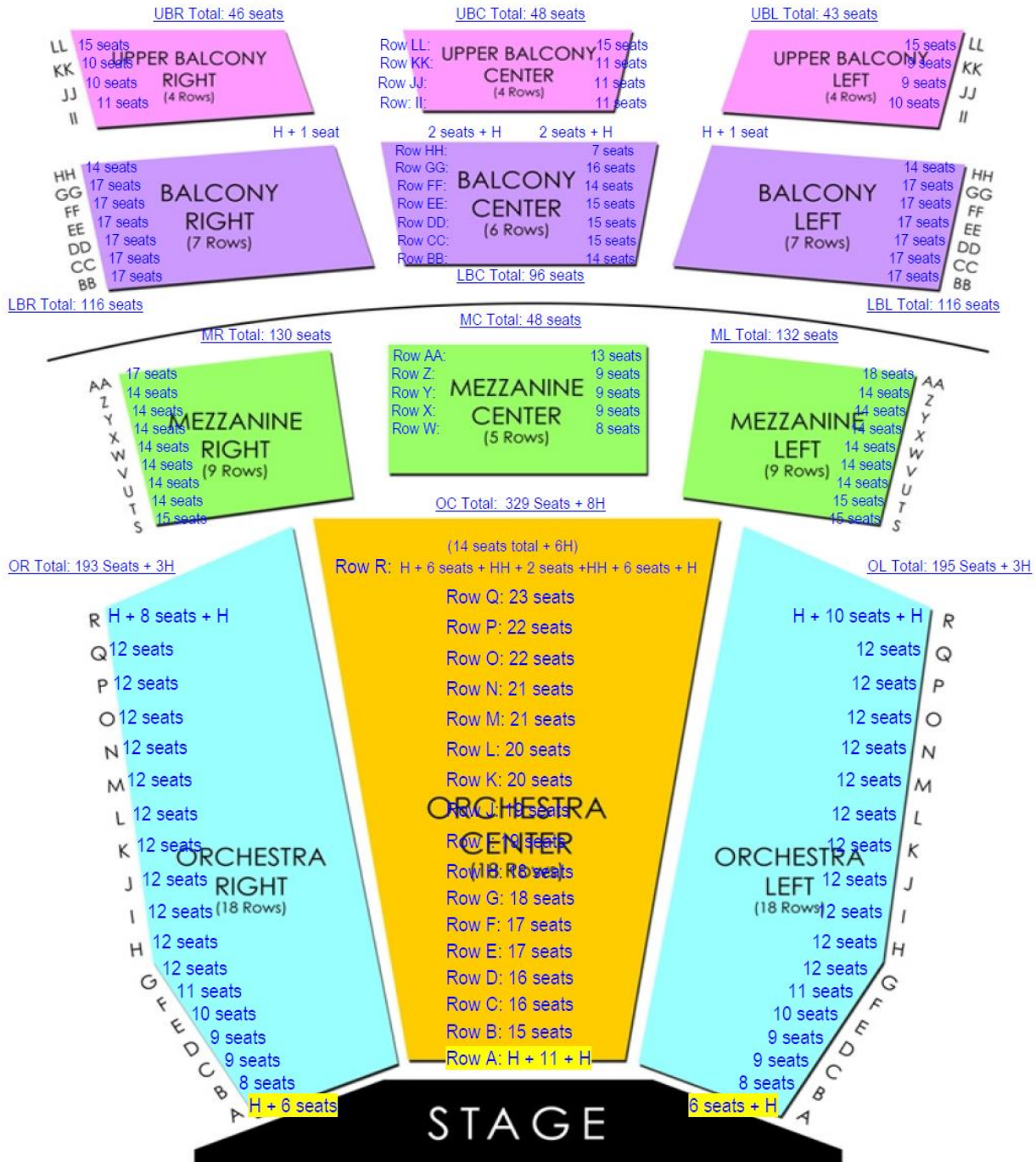

Orchestra Total: 717 Seats + 14H Mezzanine Total: 310 Seats Floor Total: 1,027 Seats + 14H

PAC HOUSE TOTAL: 1,492 SEATS + 18 Handicapped Spaces + 6 Helper Seats

LOCAL CONVENIENCE GUIDE

The BAPAC does not recommend any one business over another. This list has been compiled for the convenience of visiting artists and crew. The omission of any hotel, restaurant, service or the order of listings in no way reflects any priority or preference.

HOTELS

Stoney Creek Hotel (Special room rates available)

200 W. Albany St.

Broken Arrow, OK 74012

918-416-8100

www.stoneycreekhoteles.com/hotel/travel/brokenarrow/home.do

LaQuinta Inn & Suites

451 W Albany St.

Broken Arrow, OK 74012

918-615-3400

www.laquintabrokenarrow.com/content/lq/microsites/usa/ok/broken-arrow/6667/en/home.html/en/home.html/

Hilton Garden Inn

420 West Albany St.

Broken Arrow, OK 74012

918-940-8444

<https://hiltongardeninn3.hilton.com/en/hotels/oklahoma/hilton-garden-inn-tulsa-broken-arrow-TULARGI/index.html>

TownePlace Suites

2251 N. Stonewood Cir.

Broken Arrow, OK 74012

918-355-9600

www.marriott.com/hotels/travel/tults-towneplace-suites-tulsa-broken-arrow/

Clarion Hotel

2600 N. Aspen

Broken Arrow, OK 74012

918-258-7085

www.clarionhotel.com/hotel-broken_arrow-oklahoma-OK161

Hampton Inn

2300 W. Albany St.

Broken Arrow, OK 74012

918-251-6060

<http://hamptoninn.hilton.com/en/hp/hotels/index.jhtml?ctyhocn=TULBAHX>

Holiday Inn Express

2201 N. Stonewood Cir.
Broken Arrow, OK 74012
918-355-3200

http://www.ihg.com/holidayinnexpress/hotels/us/en/broken-arrow/tulba/hoteldetail?cm_mmc=mdpr-_-googlemaps-_-ex-_-tulba

Quality Inn

2301 W. Concord St.
Broken Arrow, OK 74012
918-258-8585

www.qualityinn.com/hotel-broken_arrow-oklahoma-OK415

RESTAURANTS – DINE-IN/TAKE OUT (Within walking distance)**Main Street Tavern**

200 S. Main St.
Broken Arrow, OK 74012
918-258-3200
www.mainstreettavernba.com

Duffy's Restaurant

706 S. Elm Pl.
Broken Arrow, OK 74012
918-251-3285

Andolini's Pizzeria

222 S Main St.
Broken Arrow, OK 74012
918-940-2770
www.andopizza.com

The Rooftop

214 S. Main St.
Broken Arrow, OK 74012
918-806-2603

Franklin's Pork and Barrel

203 S. Main St.
Broken Arrow, OK 74012
918-286-6770
www.franklinspork.com

Toast

201 S. Main St.
Broken Arrow, OK 74012
918-286-6770
www.franklinspork.com

McHuston Book Seller & Irish Bistro

122 S. Main St.
Broken Arrow, OK 74012
918-258-3301
www.larryhoeftling.com

Tasty Treat

1537 S. Main St.
Broken Arrow, OK 74012
918-251-5252

Fiesta Mambo

219 S. Main St.
Broken Arrow, OK 74012
918-455-0356
www.fiestamambo.com

Water Edge Winery

116 S. Main St.
Broken Arrow, OK 74012
918-286-0086
www.wewba.com

In the Raw

216 S. Main St.
Broken Arrow, OK 74012
www.intherawsushi.com/contact.htm

Cheri Ann's Trattoria

423 North Main St.
Broken Arrow, OK 74012
[www.facebook.com/pages/
category/Italian-Restaurant/Cheri-
Anns-Trattoria-2101982743163865/](http://www.facebook.com/pages/category/Italian-Restaurant/Cheri-Anns-Trattoria-2101982743163865/)

RESTAURANTS – DINE-IN/TAKE OUT**Oklahoma Joe's BBQ**

333 W. Albany St.
Broken Arrow, OK 74012
918-355-0000
www.okjoes.com

Charleston's

251 Hillside Dr.
Broken Arrow, OK 74012
918-355-9177
<http://charlestons.ehsrg.com/>

Rib Crib

121 W. Kenosha St.
Broken Arrow, OK 74012
918-258-1559
www.ribcrib.com

Stone Mill BBQ and Steakhouse

2000 West Reno
Broken Arrow, OK 74012
918-258-4227
www.restauranteur.com/stonemillbbq/

Ron's Hamburgers

1913 S. Elm Pl.
Broken Arrow, OK 74012
918-451-7667
www.ronschili.com

Los Cabos Mexican Grill

151 E. Bass Pro Dr.
Broken Arrow, OK 74012
918-355-8877
www.loscabosok.com

Hideaway Pizza

1150 N. 9th St.
Broken Arrow, OK 74012
918-286-1777
www.hideawaypizza.com

Shiloh's Restaurant

2604 N. Aspen Ave.
Broken Arrow, OK 74012
918-254-1500
www.shilohsrestaurant.com

Egg it On Café

1131 S. Aspen Ave.
Broken Arrow, OK 74012
918-254-0455
www.eggitoncafe.com

Ted's Café Escondido

3202 W. Kenosha
Broken Arrow, OK 74012
918-254-8337
www.tedscafe.com

Panera Bread

2201 W. Detroit St.
Broken Arrow, OK 74012
918-258-7700
www.panerabread.com

McAllister's Deli

720 N. Aspen Ave.
Broken Arrow, OK 74012
918-258-3354
www.mcalistersdeli.com

RESTAURANTS – FAST FOOD

Qdoba Mexican Grill

2401 W. Kenosha St.
Broken Arrow, OK 74012
918-994-7385

Subway

1003 N. Elm Pl.
Broken Arrow, OK 74012
918-258-0782

Burger King

1600 N. Elm Pl.
Broken Arrow, OK 74012
918-258-4470

Taco Bueno

1810 N. Elm Pl.
Broken Arrow, OK 74012
918-258-6464

Schlotzsky's

1250 E. Kenosha St.
Broken Arrow, OK 74012
918-258-7878

Sonic

2220 W. Kenosha St.
Broken Arrow, OK 74012
918-251-1632

Dickey's Barbecue Pit

820 N. Aspen
Broken Arrow, OK 74012
918-208-0777

CATERING

Panera Bread

2201 W. Detroit St.
Broken Arrow, OK 74012
918-258-7700
<http://catering1.panerabread.com/Home.aspx>

Zio's Italian Kitchen

Long John Silvers

1000 S. Elm Pl.
Broken Arrow, OK 74012
918-258-9119

Church's Chicken

415 S. Elm Pl.
Broken Arrow, OK 74012
918-286-1072

Braum's

804 N. Elm Pl.
Broken Arrow, OK 74012
918-258-2424

Egg Roll Express

807 N. Elm Pl.
Broken Arrow, OK 74012
918-251-1121

Arby's

624 W. Kenosha St.
Broken Arrow, OK 74012
918-258-7477

Charlie's Chicken

800 N. Aspen
Broken Arrow, OK 74012
918-259-0055

McAllister's Deli

720 N. Aspen Ave.
Broken Arrow, OK 74012
918-258-3354
www.mcalistersdeli.com/catering

Rib Crib

7111 S. Mingo Rd.
Tulsa, OK 74133
918-250-5999
<http://www.zios.com/site/index.php/catering>

Charlie's Chicken

800 N. Aspen
Broken Arrow, OK 74012
918-259-0055
<http://www.charlies-chicken.com/cater.html>

212 W. Kenosha St.
Broken Arrow, OK 74012
1-800-275-9677
<http://ribcrib.com/grub/catering/>

Charleston's

251 Hillside Dr.
Broken Arrow, OK 74012
918-355-9177
<http://charlestons.ehsrg.com/>

CONVENIENCE STORES

QuikTrip

501 W. Kenosha Ave.
Broken Arrow, OK 74012
918-258-8600

Fiesta Mart

830 N. Elm Pl.
Broken Arrow, OK 74012
918-259-5045

Kum & Go

1000 E. Kenosha St.
Broken Arrow, OK 74012
918-258-3544

SUPERMARKETS

WalMart Supercenter

2301 W. Kenosha St.
Broken Arrow, OK 74012
918-259-9126

Reasor's

1100 E. Kenosha St.
Broken Arrow, OK 74012
918-251-5800

BANKING

AVB / Arkansas Valley State Bank

322 S. Main St.
Broken Arrow, OK 74012
918-251-9611

MidFirst Bank

2100 W. Kenosha St
Broken Arrow, OK 74102
918-258-4403

Bank of America

1800 S, Elm Pl.
Broken Arrow, OK 74102
918-258-1480

1st National Bank

121 S. Main St.
Broken Arrow, OK 74012
918-251-5371

LAUNDRY

Liberty Laundry

709 N. 9th St.
Broken Arrow, OK 74012
918-251-7222

Quick Clean Laundry

1906 S. Elm Pl.
Broken Arrow, OK 74012
918-451-1722

DRY CLEANING**Comet Cleaners**

697 N. Aspen Ave.
Broken Arrow, OK 74012
918-258-0558

La Mode Cleaners

1218 E. Kenosha St.
Broken Arrow, OK 74012
918-258-4849

HARDWARE**Westlake Ace Hardware**

708 S. Aspen Ave.
Broken Arrow, OK 74012
918-258-1261

AUTO / AUTO REPAIR**Advantage Auto Repair**

213 E. Kenosha St.
Broken Arrow, OK 74012
918-259-9899

Jiffy Lube

100 N. Elm Pl.
Broken Arrow, OK 74012
918-251-2579

Autozone

811 S Elm Pl
Broken Arrow, OK 74012

Diamond Washtub and Cleaners

815 W. Houston St.
Broken Arrow, OK 74012
918-251-1102

Yale Cleaners

2204 S. Aspen Ave.
Broken Arrow, OK 74012
918-451-2982

Lowe's

1900 E. Hillside Dr.
Broken Arrow, OK 74012
918-355-4926

M&M Automotive

605 North Walnut Avenue
Broken Arrow, OK 74012
918-251-4750

O'Reilly's Auto Parts

501 S. Elm Pl.
Broken Arrow, OK 74012
918-251-6121

918-258-4330

HOSPITALS

St. John Broken Arrow
1000 West Boise Circle
Broken Arrow, OK 74012
918-994-8000

Saint Francis Broken Arrow
3000 South Elm Place
Broken Arrow, Oklahoma 74012
918-455-3535

PHARMACY

Walgreen's (Walking Distance)
701 W Houston St
Broken Arrow, OK 74012
918-251-7924

CVS
1853 South Aspen Avenue
Broken Arrow, OK 74012
918-251-9615

TECHNICAL THEATRE SERVICES

Performance Stage
5946 E. 12th ST.
Tulsa, OK 74112
918-832-8800
www.performance-stage.com

Integrity Lighting & Sound
3525 E. 36th ST. N.
Tulsa, OK 74115
918-425-4446
www.integritylighting.com